

wh



60 Bolsover Road

Hove BN3 5HP

Asking price of £515,000

- THREE BEDROOMS
- SHOWER ROOM
- KITCHEN
- LIVING/DINING ROOM
- WEST FACING REAR GARDENS
- GARAGE
- NARROW DRIVEWAY
- UPVC DOUBLE GLAZED WINDOWS

wh
whitlock & heaps

01273 778577
whitlockandheaps.co.uk

This attractive red brick property forms part of this larger EPC Rating: Current 21F Potential 80C than average plot featuring a narrow drive leading to the detached garage. The three bedroom accommodation offers tremendous potential to a prospective buyer with scope for extension (stnc). The family home currently has a separate kitchen and through living/dining room that leads onto the West facing rear garden.

ENTRANCE HALL Understairs cupboard, heater.

KITCHEN Incorporating stainless steel sink unit with drainer and mixer tap, adjacent laminate work surface with cupboards and drawers under, matching eye-level wall cupboards, inset 4-ring gas hob with extractor over, oven, space for fridge/freezer and plumbing for washing machine, tiled splashback, UPVC double glazed window and door to garden.

LIVING/DINING ROOM UPVC double glazed bay window, two heaters, 'French' doors to garden.

FIRST FLOOR

LANDING Fitted cupboard, hatch to loft space with pull-down ladder and velux window.

BEDROOM 1 Range of fitted wardrobes and drawers, UPVC double glazed bay window, heater.

BEDROOM 2 Two fitted double cupboards, UPVC double glazed window, heater.

BEDROOM 3 UPVC double glazed window, heater, fitted wardrobe.

SHOWER ROOM Comprising walk-in shower, pedestal wash-hand basin, low level w.c., UPVC double glazed frosted window, tiled walls and floor.

OUTSIDE

FRONT GARDEN Narrow driveway leading to:-

GARAGE Double doors, power and light, work bench.

WEST FACING REAR GARDEN Apple, pear and plum trees, raised borders, brick built store.

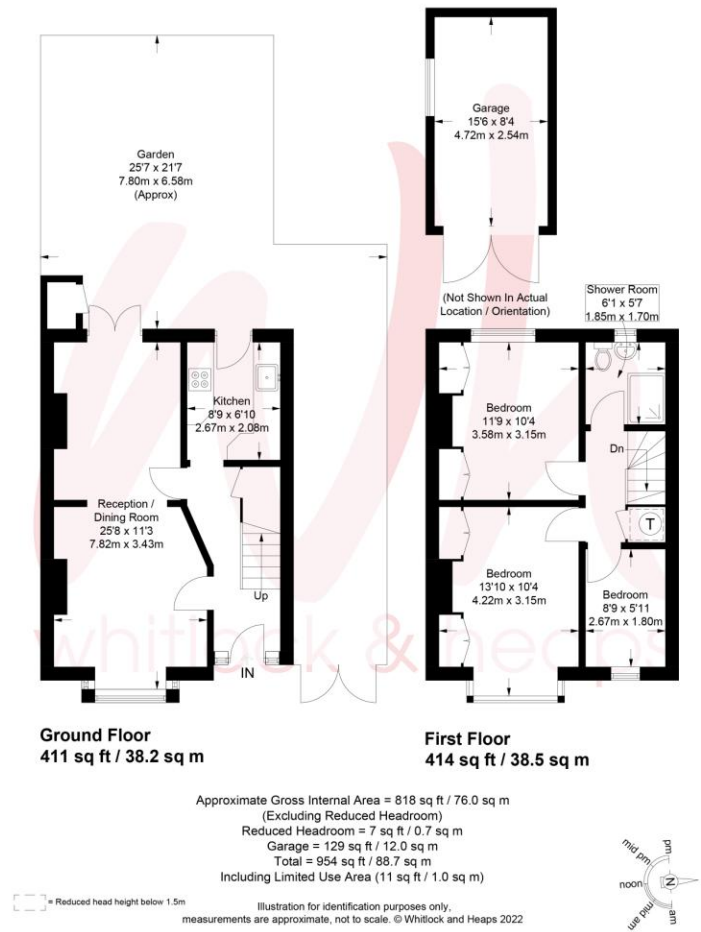

Portslade Branch
48 Boundary Road, Portslade BN3 4EF
portslade@whitlockandheaps.co.uk
01273 422706

Hove Branch
65 Sackville Road, Hove BN3 3WE
hove@whitlockandheaps.co.uk
01273 778577



Disclaimer: Whitlock & Heaps have produced these particulars in good faith and they are set out as a general guide. Accuracy is not guaranteed, nor do they form part of any contract. If there is any particular aspect of these details which you require any confirmation, please do contact us, especially if contemplating a long journey. All measurements are approximate. Fixtures and fittings, other than those mentioned above, to be agreed with the seller. Any services, systems or appliances at the property have not been tested.