

wh



4 Prinsep Road, Hove BN3 7AB

£750,000

- THREE DOUBLE BEDROOMS
- WHITE FAMILY BATHROOM SUITE
- TWO SEPARATE TOILETS
- STUNNING EXTENDED KITCHEN/LIVING ROOM
- SOUTH FACING SITTING ROOM
- DINING ROOM
- REAR PATIO GARDEN
- RETENTION OF PERIOD FEATURES

wh
whitlock & heaps

01273 778577
whitlockandheaps.co.uk

This attractive bay fronted family home has been skilfully extended by the present owners offering a delightful kitchen/living room leading onto the secluded rear garden. The three double bedroom accommodation is presented in excellent order throughout with an abundance of original features including the open fireplace in the living room. Situated in the favoured 'Artists' corner of Hove being within walking distance of Hove mainline station and Hove Park. An abundance of eateries, cafes and shopping facilities are easily accessible on Church Road as is the seafront.

The accommodation with approximate room measurements comprises;

ENTRANCE HALL

Cupboard, radiator, meter cupboard.

CLOAKROOM

Comprising low level w.c, wash hand basin.

KITCHEN/LIVING ROOM

Having been skilfully and tastefully extended by the present owners offering a delightful entertaining space. Incorporating 1 ½ bowl sink unit with mixer, and insinkerator, adjacent granite worktops with wide range of cupboards and drawers under, five ring induction hob, extractor over, eye level double oven, plate warmer, plumbing for dishwasher, space for fridge/freezer, central island with oak worksurface, three large fitted cupboards one with plumbing and power for washing machine and tumble dryer, glass roof, sash window, tiled floor with underfloor heating, French doors to garden.

SITTING/DINING ROOM

Sitting Area

South facing sash bay window, open fireplace with tiled insert and marble mantle, radiator.

Dining Area

Feature fireplace with tiled insert and carved surround, radiator.

FIRST FLOOR

LANDING

Hatch to loft space.

BEDROOM 1

South facing with sash bay window and second sash to side, radiator.

BEDROOM 2

Sash window, radiator, fitted wardrobes.

BEDROOM 3

Sash window, velux, fitted wardrobes, 'Worcester' gas fired boiler.

BATHROOM

White suite comprising panelled bath with mixer tap and telephone style shower attachment, separate shower over, glazed shower screen, pedestal wash hand basin, low level w.c, sash window, part tiled walls.

SEPARATE W.C

Comprising pedestal wash hand basin, low level w.c, part tiled walls.

OUTSIDE

REAR GARDEN

Paved patio with raised borders.

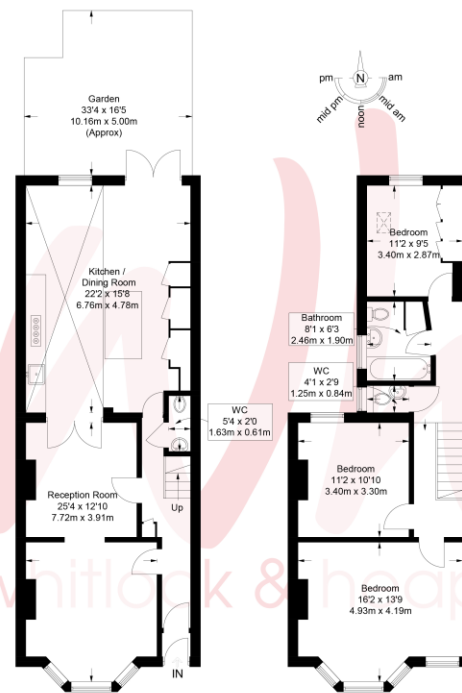

Ground Floor
759 sq ft / 70.5 sq m

First Floor
598 sq ft / 55.6 sq m

Approximate Gross Internal Area = 1357 sq ft / 126.1 sq m

Illustration for identification purposes only, measurements are approximate, not to scale. © Whitlock and Heaps 2020

Portslade Branch

48 Boundary Road, Portslade BN3 4EF
portslade@whitlockandheaps.co.uk
01273 422706

Hove Branch

65 Sackville Road, Hove BN3 3WE
hove@whitlockandheaps.co.uk
01273 778577



Disclaimer: Whitlock & Heaps have produced these particulars in good faith and they are set out as a general guide. Accuracy is not guaranteed, nor do they form part of any contract. If there is any particular aspect of these details which you require any confirmation, please do contact us, especially if contemplating a long journey. All measurements are approximate. Fixtures and fittings, other than those mentioned above, to be agreed with the seller. Any services, systems or appliances of the property have not been tested.